The Riviera HOMEOWNERS NEWSLETTER

JANUARY, 1974

WHAT ARE THE LAND-USE AND BUILDING RESTRICTIONS IN THE RIVIERA?

CAN YOU USE YOUR PROPERTY IN ANY WAY YOU CHOOSE?

CAN YOUR NEIGHBOR BUILD AN ADDITION WHICH WILL BLOCK YOUR VIEW?

RIVIERA HOMEOWNERS ASSOCIATION

SPECIAL MEETING

January 7, 1974 - 8:00 p.m.

PARKWAY SCHOOL CAFETORIUM

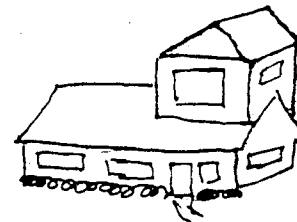
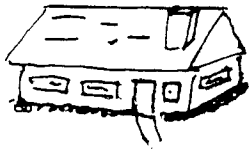

STANLEY DUNN, Community Association Art Jury Chairman, will explore and discuss:

- ✓ The history and content of Riviera deed restrictions.
- ✓ The relevancy and effectiveness of the Hollywood Riviera Community Association and its Art Jury (created at the time of the original Riviera subdivision - currently unknown to most residents).
- ✓ The role of the Riviera Homeowners Association in a possible re-constitution of the Community Association and Art Jury.

ALSO

- ✓ What, if any, guidelines should be established to assure architectural compatibility, property maintenance and the preservation of scenic views?
- ✓ By whom could such guidelines be enforced?
- ✓ These are matters vital to all Riviera residents, bearing not only on the quality of life in the area, but directly affecting property values. We urge you to attend, to listen and to make yourselves heard. RHA feels strongly that any decisions made on these issues will be valid only to the degree to which Rivierans take part in making them.

Bob White, President (373-1901)